

ROOFING IN PVC-P BALLASTED BY GRAVEL

Cold roof: with sealing element placed on top of the supporting element without thermal insulation

TOTALLY INDEPENDENT SYSTEM REINFORCED CONCRETE SUBSTRATE



■ SUPPORTING ELEMENT or SUBSTRATE

The surface must:

1. Be smooth and free from debris and irregularities that may cause damage to the layers above
2. Be stable over time
3. Be chemically compatible with the roofing system components
4. Have an adequate slope. A flat or sub-horizontal roof must have a slope ranging from 1.5 and 5 %.

■ ADJUSTMENT LAYER-COMPENSATION

FLAG geotextile PP, felt, non-woven, polypropylene whose weight ranges from minimum 500 g/m² depending upon the condition of the support.

■ SEALING ELEMENT

FLAGON SV synthetic membrane in PVC-P dimensionally stabilised with a layer of glass fibre (50 g/m²), resistant to weathering, ultraviolet rays and to root growth. It has a signal layer and it is hot air welded on the sheet overlaps.

The perimeter fixing at the base of the upstand must be performed with **Flag pre-drilled bar** in galvanised sheet iron.

Insert **Flag anti-puncturing joint** at the junction between two adjacent bars and hot-weld the tear prevention curb **FLAGOFIL PVC**.

Anti-root membrane, FLL certified.

■ FILTRATION LAYER

FLAG geotextile PET, felt, non-woven, polyester whose weight ranges from minimum 300 g/m² depending upon the condition of the support.

■ BALLASTING AND PROTECTION LAYER (GRAVEL)

River-washed, round gravel 12/35 mm, loose-laid to a minimum depth > cm 5.0 in order to prevent wind from lifting or moving the dry-laid stratification package.

	FLAGON SV		
	STANDARD SYSTEM	OPTIMUM SYSTEM	REINFORCED SYSTEM
Finishing	GRAVEL	GRAVEL	GRAVEL
Filtration layer	Non-woven felt PET ≥ 300 g/m ²	Non-woven felt PET ≥ 300 g/m ²	Non-woven felt PET ≥ 300 g/m ²
Sealing element	SV - 1.5 mm	SV - 2.0 mm	SV - 2.4 mm
Adjustment layer	Non-woven felt PP ≥ 500 g/m ²	Non-woven felt PP ≥ 500 g/m ²	Non-woven felt PP ≥ 500 g/m ²
Slopes	1.5 % ≤ P ≤ 5 %	1.5 % ≤ P ≤ 5 %	1.5 % ≤ P ≤ 5 %

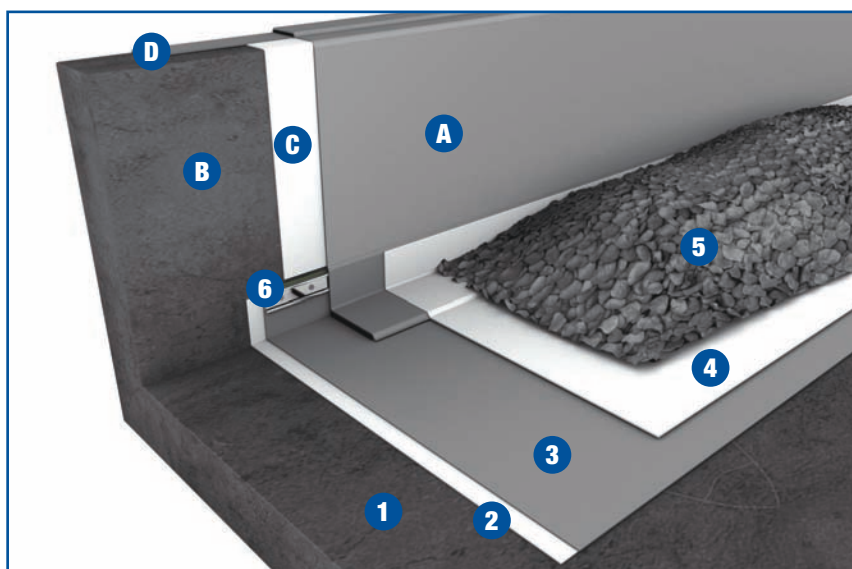

Horizontal surface

1. Supporting element
2. Adjustment layer
3. **FLAGON SV**
4. Filtration layer
5. Ballasting layer (Gravel)
6. Perimeter pre-drilled bar

Vertical surface

- FLAGON SV**
- h<50 cm FLEXOCOL V vertical gluing layer
h>50 cm mechanical fixing
- Separating layer in non-woven felt (non-adhered roof system)
- Possible finishing elements:
 - Flagmetal termination strip and flashing
 - Flagmetal strip under cap
 - Flagmetal perimeter profile