

RE-COVER ROOFING WITH EXPOSED PVC WATERPROOF LINER LAID ON ADJUSTMENT PANEL

Warm roof: with sealing element placed on top of the insulating element
MECHANICAL FASTENING SYSTEM



SUPPORTING ELEMENT or SUBSTRATE

The surface must:

1. Be sound, clean and free from debris and sharp projections that may cause damage to the layers above. In order to correct an existing bituminous wrinkled membrane, remove the wrinkles by cutting/torching.
2. Be stable over time.
3. Be chemically compatible with the new roofing system components.
4. be suitable for mechanical fixing.
5. have an adequate slope. A flat or sub-horizontal roof must have a slope ranging from 1.5 and 5%.
6. Where possible, remove all guttering, profiles and all existing waterproofing layers from the vertical upstands.

ADJUSTMENT PANEL WITH INSULATION ELEMENT

- It must have an adequate compressive resistance (UNI EN 826).
- The insulation panels should be fully bonded in order to avoid unabsorbed water and allow the overlaps to be adequately hot air welded.
- Dry laid mechanically fixed through the existing PVC or bituminous proofing system.
- It must have an adequate thickness in order to take up any surface irregularities of the substrate and panels should be interlocking with male/female joint.

SEPARATING LAYER

Heat treated FLAG geotextile PET, felt, non-woven, polyester whose weight ranges from minimum 200 g/m².

SEALING ELEMENT

FLAGON SR M2, synthetic membrane in PVC-P reinforced with a polyester mesh, resistant to tearing under wind stress, resistant to ultraviolet rays, to puncturing, to weathering, and to root growth. It has signal layer and it is heat welded on the sheet overlaps.

It's BROOF T3 certified membrane according to UNI EN 13501-5 and UNI ENV 1187 fire classification from external fire exposure (note 1).

Mechanical fixing by expansion fixing plugs and distribution plates for concrete substrate (note 2).

The perimeter fixing at the base of the upstand must be performed with Flag pre-drilled bar in galvanized sheet iron.

Insert Flag anti-puncturing joint at the junction between two adjacent bars and hot-weld the tear prevention curb FLAGOFIL PVC.

PROTECTION

Where pedestrian traffic and pedestrian transit for maintenance operations is possible, the system must be protected by means of FLAGON WALKWAY PVC, a anti-puncturing membrane.

FLAGON SR M2*

	STANDARD SYSTEM	OPTIMUM SYSTEM	REINFORCED SYSTEM
Sealing element	SR M2 - 1.5 mm	SR M2 - 2.0 mm	SR M2 - 2.4 mm
Separating layer	Non-woven felt PET ≥ 200 g/m ²	Non-woven felt PET ≥ 200 g/m ²	Non-woven felt PET ≥ 200 g/m ²
Adjustment panel	YES	YES	YES
Slopes	1.5 % ≤ P ≤ 5 %	1.5 % ≤ P ≤ 5 %	1.5 % ≤ P ≤ 5 %
Existing proofing system	PVC or Bituminous	PVC or Bituminous	PVC or Bituminous

*If a fire certificate in accordance with UNI EN 13501-5 and UNI ENV 1187 is not required, standard FLAGON EP/PR can be used.

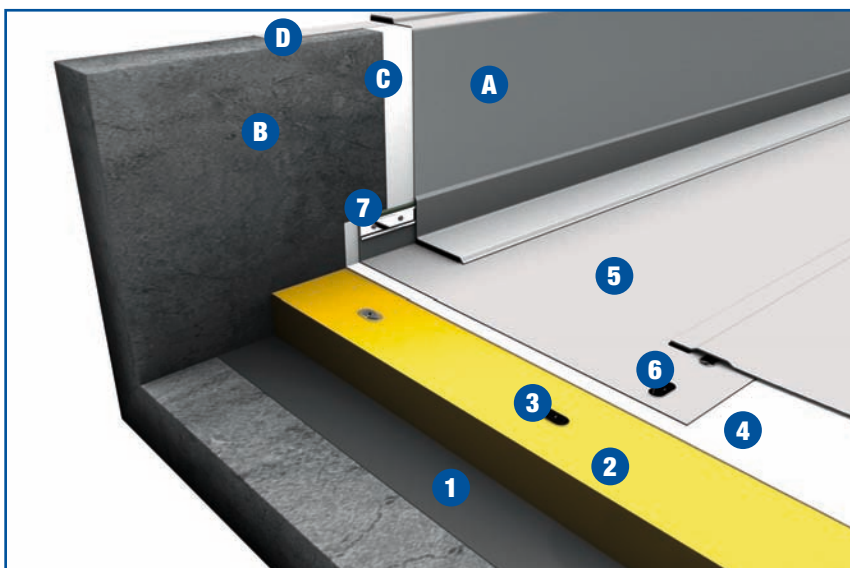

Horizontal surface

1. Supporting element: PVC liner or existing bituminous membrane
2. Adjustment panel
3. Fixing element
4. Separating layer
5. FLAGON SR M2
6. Fixing elements
7. Perimeter fixing by pre-drilled bar

Vertical surface

- A. FLAGON SR M2
- B. h<50 cm FLEXOCOL V vertical gluing layer
h>50 cm mechanical fixing
Important Note:
1_ Before gluing, remove the existing proofing system from the upstands.
2_ When removing the existing bitumen from the upstands, a separating layer in non-woven felt must be inserted and mechanical fixing must always be applied.
- C. Separating layer in non-woven felt (non-adhered roof system)
- D. Possible finishing elements:
- Flagmetal termination strip and flashing
- Flagmetal strip under cap
- Flagmetal perimeter profile

Note 1: to meet the requirements of a waterproof roof system BROOF T3 certified in accordance with UNI EN 13501-5 and UNI ENV 1187, a certified PVC membrane together with all the accessories approved by Flag must be applied. When planning the re-roofing with the BROOF T3 Certification of existing proofing systems, please consult with our FLAG team of experts.

Note 2: The membrane should be mechanically fastened in accordance with UNI EN 1991-1-4:2005 certified instructions provided by the manufacturer.

Flag S.p.A. - SOPREMA GROUP

v. Industriale dell'Isola 3 24040 Chignolo d'Isola (BG) T.+39.035.0951011 F.+39.035.4940649 e-mail:info@flag.it website:www.flag.it

For technical information: tech-office@flag.it

