

RE-COVER ROOFING WITH EXPOSED PVC-P WATERPROOF LINER

Sealing element placed on top of the existing synthetic coating

FULLY ADHERED ROOFING SYSTEM

4b2



■ SUPPORTING ELEMENT or SUBSTRATE

The surface must:

1. Be sound, clean and free from debris and irregularities that may cause damage to the layers above. In order to make surface smooth and even remove local depressions by cutting or torching.
2. Be stable over time
3. Be chemically compatible with the new roofing system components
4. be suitable for gluing
5. be fully bonded to the substrate to prevent the wind from lifting or moving it (in compliance with standard UNI EN 1991-1-4:2005). Note: if the existing membrane is not fully adhered to the supporting element, it must be first firmly fastened in accordance with standard UNI EN 1991-1-4:2005.
6. have an adequate slope. A flat or sub-horizontal roof must have a slope ranging from 1.5 and 5%
7. Where possible, remove all guttering, profiles and all existing waterproofing layers from the vertical upstands.

■ SEALING ELEMENT

FLAGON SFc synthetic membrane of plasticised PVC with the addition of a 50 g/m² glass fibre reinforcement for stability and coupled to 200 g/m² non-woven polyester felt support. Resistant to ultraviolet rays, to puncturing, to weathering, and to root growth. It has signal layer and it is heat welded on sheet overlaps.

Fully adhered system by means of **FLEXOCOL A89**, a mono-component adhesive formulated with polyurethane. To obtain the better result, depending on the support surface, use between 300 and 500 g/m².

The perimeter fixing at the base of the upstand must be performed with **Flag pre-drilled bar** in galvanised sheet iron.

Insert **Flag anti-puncturing joint** at the junction between two adjacent bars and hot-weld the tear prevention curb **FLAGOFIL PVC**.

Anti-root membrane, FLL certified.

■ PROTECTION

Where pedestrian traffic and pedestrian transit for maintenance operations is possible, the system must be protected by means of **FLAGON WALKWAY PVC**, a anti-puncturing membrane.

	FLAGON SFc		
	STANDARD SYSTEM	OPTIMUM SYSTEM	REINFORCED SYSTEM
Sealing element	SFc - 1.5 mm	SFc - 2.0 mm	SFc - 2.4 mm
Slopes	1.5 % ≤ P ≤ 5 %	1.5 % ≤ P ≤ 5 %	1.5 % ≤ P ≤ 5 %
Existing proofing system	PVC	PVC	PVC

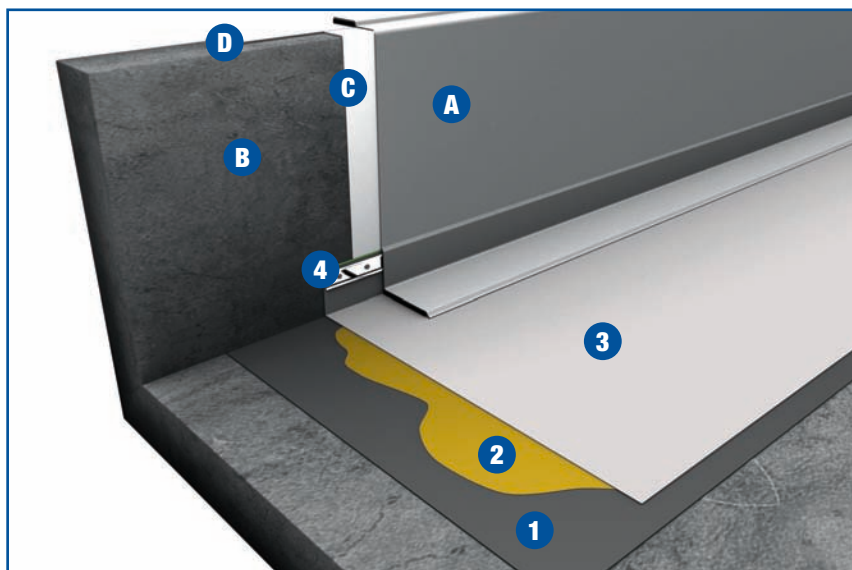

Horizontal surface

1. Existing support element: PVC membrane
2. FLEXOCOL A89
3. FLAGON SFc
4. Perimeter pre-drilled bar

Vertical surface

- A. FLAGON SV
- B. h<50 cm FLEXOCOL V vertical gluing layer
h>50 cm mechanical fixing
Important Note:
1_ Before gluing, remove the existing proofing system from the upstands.
2_ When removing the existing bitumen from the upstands, a separating layer in non-woven felt must be inserted and mechanical fixing must always be applied.
- C. Separating layer in non-woven felt (non-adhered roof system)
- D. Possible finishing elements:
- Flagmetal termination strip and flashing
- Flagmetal strip under cap
- Flagmetal perimeter profile

Flag S.p.A. - SOPREMA GROUP

v. Industriale dell'Isola 3 24040 Chignolo d'Isola (BG) T.+39.035.0951011 F.+39.035.4940649 e-mail:info@flag.it website:www.flag.it

For technical information: tech-office@flag.it



FLAG SpA reserves the right, in light of changes in knowledge and techniques, to alter without notice the composition and terms of use of its materials as well as the systems in which they are inserted.