

# ROOFING IN PVC-P WITH GREEN ROOF (SOPRANATURE)

Inverted roof: with sealing element placed underneath the thermal insulation  
**TOTALLY INDEPENDENT SYSTEM • REINFORCED CONCRETE SUBSTRATE**



## ■ SUPPORTING ELEMENT or SUBSTRATE

The surface must:

1. Be smooth and free from debris and irregularities that may cause damage to the layers above
  2. Be stable over time
  3. Be chemically compatible with the roof system components
  4. Have an adequate slope. A flat or sub-horizontal roof must have a slope ranging from 1.5 and 5 %.
- Important Note: structural load capacity must be considered before choosing and specifying each particular system. The structure's ability to support the additional weight (dead and live load) of a SOPRANATURE system must first be evaluated and approved by a professional engineer charged to the client.

## ■ ADJUSTMENT LAYER-COMPENSATION

**FLAG** geotextile PP, felt, non-woven, polypropylene whose weight ranges from minimum 500 g/m<sup>2</sup> depending upon the condition of the support.

## ■ SEALING ELEMENT

**FLAGON SV**, synthetic membrane in PVC-P with a layer of glass fibre (50 g/m<sup>2</sup>) inserted for dimensional stability, resistant to weathering, ultraviolet rays and to root growth. It has a signal layer and it is hot air welded on the sheet overlaps.

The perimeter fixing at the base of the upstand must be performed with **Flag pre-drilled bar** in galvanised sheet iron.

Insert **Flag anti-puncturing joint** at the junction between two adjacent bars and hot-weld the tear prevention curb **FLAGOFIL PVC**.

**Anti-root membrane, FLL certified.**

## ■ SEPARATING LAYER

**FLAG** geotextile PET, felt, non-woven, polyester whose weight ranges from minimum 200 g/m<sup>2</sup> depending upon the condition of the support.

## ■ INSULATION ELEMENT

- Made from panel industrial XPS (or equivalent) suitable for inverted roof.
- Dry-laid on the separating layer.
- It must have an adequate compressive resistance (UNI EN 826).
- The insulation boards should be fully bonded in order to avoid unabsorbed water.

## ■ PROTECTION LAYER

**FLAGON TS** anti-puncturing liner made of a coated PVC film, 0.40 mm thick coupled to 120 g/m<sup>2</sup> non-woven felt in polyethelene. The unrolled sheets must be welded on the outside edges to provide a complete homogeneous protection layer.

## ■ SOPRANATURE SYSTEM

Installation of green roof system by means of SOPRANATURE package as described below.

	FLAGON SV		
	STANDARD SYSTEM	OPTIMUM SYSTEM	REINFORCED SYSTEM
Finishing	SOPRANATURE	SOPRANATURE	SOPRANATURE
Protection layer	FLAGON TS	FLAGON TS	FLAGON TS
Insulation element	XPS	XPS	XPS
Separating layer	Non-woven felt PET ≥ 200 g/m <sup>2</sup>	Non-woven felt PET ≥ 200 g/m <sup>2</sup>	Non-woven felt PET ≥ 200 g/m <sup>2</sup>
Sealing element	<b>SV - 1.8 mm</b>	<b>SV - 2.0 mm</b>	<b>SV - 2.4 mm</b>
Adjustment layer	Non-woven felt PP ≥ 500 g/m <sup>2</sup>	Non-woven felt PP ≥ 500 g/m <sup>2</sup>	Non-woven felt PP ≥ 500 g/m <sup>2</sup>
Slopes	1.5 % ≤ P ≤ 5 %	1.5 % ≤ P ≤ 5 %	1.5 % ≤ P ≤ 5 %

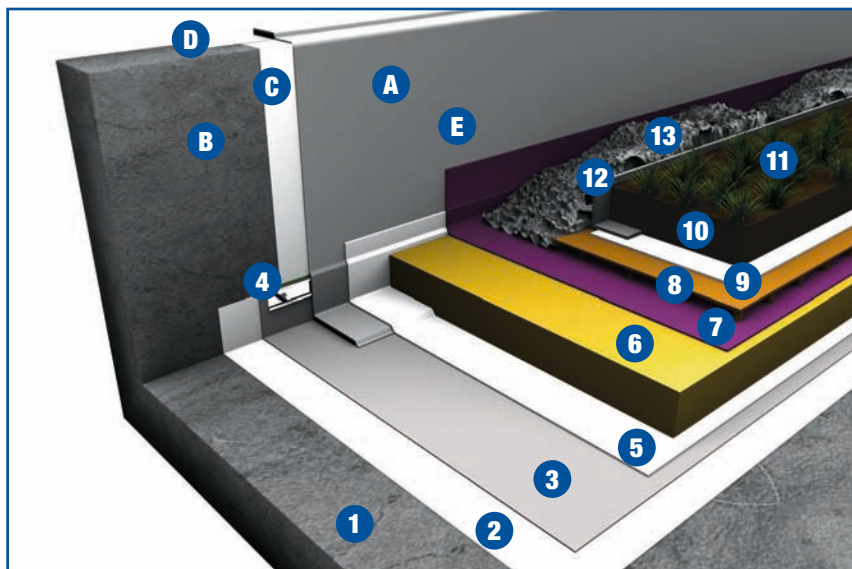

### Horizontal surface

1. Supporting element
2. Adjustment layer
3. **FLAGON SV**
4. Perimeter fixing by pre-drilled bar
5. Separating layer
6. Insulation element
7. Protection Layer
8. SOPRALITHE/SOPRADRAIN
9. SOPRAFILTRE
10. SOPRAFLOOR
11. SOPRANATURE vegetation layer
12. Curb
13. Perimeter in gravel

### Vertical surface

- A. **FLAGON SV**
- B. h<50 cm FLEXOCOL V vertical gluing layer  
h>50 cm mechanical fixing
- C. Separating layer in non-woven felt (non-adhered roof system)
- D. Possible finishing elements:  
- Flagmetal termination strip and flashing  
- Flagmetal strip under cap  
- Flagmetal perimeter profile
- E. Provide mechanical anchoring on the vertical upstands (galvanised sheet iron or equivalent)

## SOPRANATURE SYSTEM

It must be in accordance with all the technical specifications applicable to SOPRANATURE vegetated roofing systems. The green roofing system includes 4 components:

1. Drainage panel (**SOPRALITHE** or **SOPRADRAIN**);
2. Filter (**SOPRAFILTRE**);
3. Growing medium (**SOPRAFLOOR**);
4. Vegetation layer (**SOPRANATURE**) different systems are available: extensive (**Toundra**, **Pampa**, **Garrigue**) and semi-intensive (**Green e Landes**).

- It is recommended that a Soprema representative be consulted to find the right technical and financial solutions to suit the particularities of any individual project (in accordance with the selected roof system and the geographical weather conditions).

Flag S.p.A. - SOPREMA GROUP

v. Industriale dell'Isola 3 24040 Chignolo d'Isola (BG) T.+39.035.0951011 F.+39.035.4940649 e-mail:info@flag.it website:www.flag.it

For technical information: [tech-office@flag.it](mailto:tech-office@flag.it)

