

EXPOSED ROOF SYSTEM IN TPO

Warm roof: with sealing element placed on top of the thermal insulation

FULLY ADHERED SYSTEM REINFORCED CONCRETE SUBSTRATE



■ SUPPORTING ELEMENT or SUBSTRATE

The substrate must:

1. Be smooth, sound, clean and free from debris and irregularities that may cause damage to the layers above
2. Be stable over time
3. Be chemically compatible with the roofing system components
4. Suitable for gluing (suitable for receiving an adhesive layer). A more or less 3 cm thick cement cap sheet must be laid on top of lightweight screeds before gluing the waterproof package
5. Have an adequate slope. A flat or sub-horizontal roof must have a slope ranging from 1.5 and 5%.

■ VAPOUR BARRIER

It depends upon the hygrometry of the underlying structures. For further details please refer to the booklet "Vapour Barrier".

Vapour retarder consist of: Bituminous polymer membrane: **SOPRAVAP 3 in 1**.

■ INSULATION ELEMENT

- It is glued so as to fully adhere to the **SOPRAVAP 3 in 1** vapour barrier.
- Compatible with the warm roof system.
- It must have an adequate compressive resistance (UNI EN 826).
- The insulation boards should be fully bonded in order to avoid unabsorbed water and allow the overlaps to be adequately hot air welded by means of automatic equipment.

■ SEALING ELEMENT

FLAGON EP/PV-F, synthetic liner in polyolefin modified with the addition of a 50 g/m² glass fibre reinforcement for stability and coupled to 200 g/m² non-woven polyester felt support. Resistant to ultraviolet rays, to puncturing, to weathering, and to root growth. It has signal layer and it is heat welded on sheet overlaps.

Fully adhered system by means of **FLEXOCOL A89**, a mono-component adhesive formulated with polyurethane.

To obtain the better result, depending on the support surface, use between 300 and 500 g/m². The perimeter fixing at the base of the upstand must be performed with **Flag pre-drilled bar** in galvanised sheet iron.

Insert **Flag anti-puncturing joint** at the junction between two adjacent bars and hot-weld the tear prevention curb **FLAGOFIL TPO**.

Anti-root membrane, FLL certified.

■ PROTECTION

Where pedestrian traffic and pedestrian transit for maintenance operations is possible, the system must be protected by means of **FLAGON WALKWAY TPO**, an anti-slip membrane.

FLAGON EP/PV-F

	STANDARD SYSTEM	OPTIMUM SYSTEM	REINFORCED SYSTEM
Sealing element	EP/PV-F - 1.5 mm	EP/PV-F - 2.0 mm	EP/PV-F - 2.4 mm
Adhesive layer	FLEXOCOL A89	FLEXOCOL A89	FLEXOCOL A89
Insulation element	YES	YES	YES
Vapour Barrier	SOPRAVAP 3 in 1	SOPRAVAP 3 in 1	SOPRAVAP 3 in 1
Slopes	1.5 % ≤ P ≤ 5 %	1.5 % ≤ P ≤ 5 %	1.5 % ≤ P ≤ 5 %

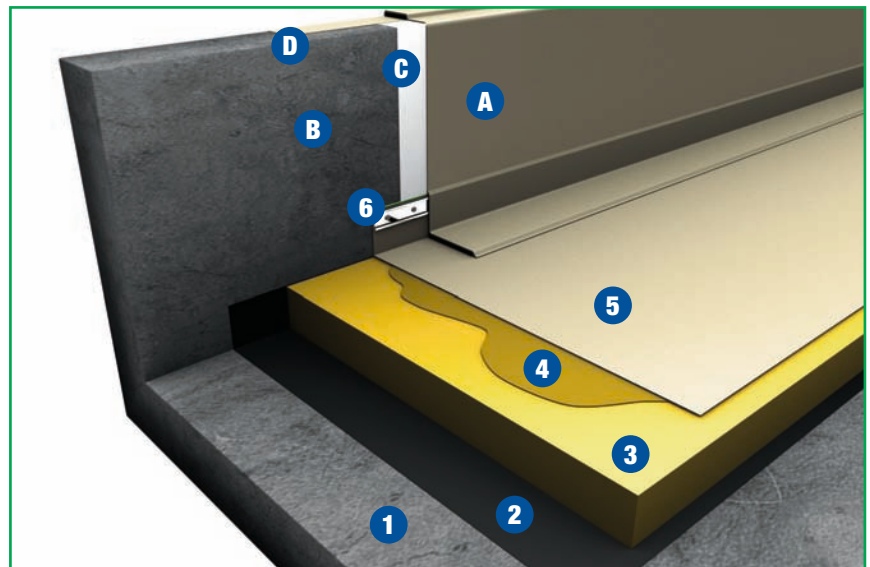

Horizontal surface

1. Supporting element
2. Vapour barrier/adhesive layer SOPRAVAP 3 IN 1
3. Insulation element
4. FLEXOCOL A89
5. **FLAGON EP/PV-F**
6. Perimeter pre-drilled bar

Vertical surface

- A. **FLAGON EP/PV**
- B. h<50 cm FLEXOCOL TPO vertical gluing layer
h>50 cm mechanical fixing
- C. Separating layer in non-woven felt (non-adhered roof system)
- D. Possible finishing elements:
 - Flagmetal termination strip and flashing
 - Flagmetal strip under cap
 - Flagmetal perimeter profile